

Tools

TUNGSTEN CARBIDE SPADE DRILL	2
SCRAPING TOOL	2
TURNING HEAD	3
CALIBRATION PIN	3
TUBULAR RAM	4
TAMPING PUNCH	9
BLANKING PUNCH / BLANKING PLATE / IMPRESS PUNCH / HOLDING DISC	9
COLLET FOR STANDARD TAMPING HEAD	10
COLLET FOR SMALL TAMPING HEAD	12
COLLET FOR SUPER LIGHT TAMPING HEAD	13
COLLET FOR HEAVY TAMPING HEAD	13
BOTTOM PLATE	14
SCISSOR BLADES	15
HAND TAMPING PIECE	16

Tungsten carbide spade drill

Diameter: 1,4 - 7,6mm
 Helix angle: 0°
 Point angle: 114°

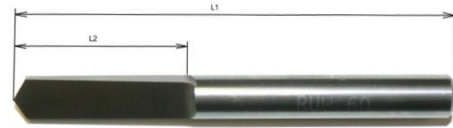
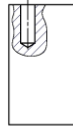

drill Ø	L1	L2	Tungsten carbide spade drill	drill Ø	L1	L2	Tungsten carbide spade drill
			Article No.				Article No.
1,4	40	14	090E01155_14	4,5	60	22	090E01155_45
1,5	40	14	090E01155_15	4,6	60	22	090E01155_46
1,6	40	14	090E01155_16	4,7	60	22	090E01155_47
1,8	40	14	090E01155_18	4,8	60	22	090E01155_48
2,0	40	14	090E01155_20	4,9	60	22	090E01155_49
2,2	50	15	090E01155_22	5,2	60	22	090E01155_52
2,6	50	18	090E01155_26	5,3	60	25	090E01155_53
2,8	50	18	090E01155_28	5,4	60	25	090E01155_54
2,9	50	18	090E01155_29	5,5	60	25	090E01155_55
3,1	50	18	090E01155_31	5,8	60	25	090E01155_58
3,2	50	18	090E01155_32	5,9	60	25	090E01155_59
3,3	60	22	090E01155_33	6,0	60	25	090E01155_60
3,5	60	22	090E01155_35	6,1	60	25	090E01155_61
3,6	60	22	090E01155_36	6,4	60	25	090E01155_64
3,7	60	22	090E01155_37	6,5	60	25	090E01155_65
3,8	60	22	090E01155_38	6,9	60	25	090E01155_69
4,0	60	22	090E01155_40	7,0	60	25	090E01155_70
4,1	60	22	090E01155_41	7,5	60	25	090E01155_75
4,3	60	22	090E01155_43	7,6	60	25	090E01155_76
4,4	60	22	090E01155_44				

Scraping tool

Use: for roughening of the drill hole to reach a better joint strength

Point angle: 60°
 Type: 90E1047b one scrape pin
 Type: 90E1047_2 two scrape pin
 Length L1: 60
 Shaft Ø: 4-6

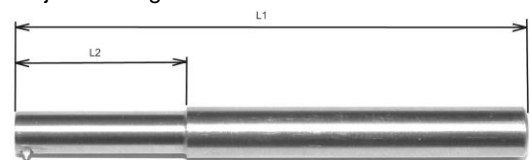
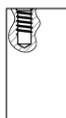

scrape Ø	drill Ø	L2	one pin 90E1047b Article No.	two pin 90E1047_2 Article No	scrape Ø	drill Ø	L2	one pin 90E1047b Article No	two pin 90E1047_2 Article No
2,3	1,8	15	23150401	23150402	4,8	4,1	25	48250601	48250602
2,5	2,0	15	25150401	25150402	4,9	4,2	25	49250601	49250602
2,9	2,4	15	29150401	29150402	5,0	4,2	25	50250601	50250602
3,1	2,8	20	31200401	31200402	5,2	4,4	25	52250601	52250602
3,2	2,6	20	32200401	32200402	5,3	4,5	25	53250601	53250602
3,3	2,7	20	33200401	33200402	5,4	4,6	25	54250601	54250602
3,4	2,8	20	34200401	34200402	5,5	4,7	25	55250601	55250602
3,5	2,9	20	35200601	35200602	5,7	4,9	25	57250601	572 50602
3,6	3,0	20	36200601	36200602	6,0	5,2	25	60250601	60250602
3,8	3,2	20	38200601	38200602	6,5	5,7	25	65250601	65250602
3,9	3,3	20	39200601	39200602	7,1	6,3	25	71250601	71250602
4,0	3,4	20	40200601	40200602	7,6	6,8	30	76300601	76300602
4,2	3,5	20	42200601	42200602	8,5	7,6	30	85300601	85300602
4,4	3,7	20	44200601	44200602					
4,5	3,8	20	45200601	45200602					
4,7	4,0	20	47200601	47200602					

Special designs (smaller diameter, full carbide) on demand



Turning head

Use: for turning a head on carbon brushes with or without hole
 turn diameter: adjustable
 drill diameter: on request
 turn angle: 90° (special angle on demand)

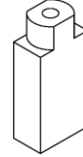

	Turning head	Turning head	Turning head
Article no:	9021001	901240	901240_2
turn Ø	adjustable 4 - 9	adjustable 3-11	adjustable 5 - 16
drill Ø max	3,18	4,0	5,0
shaft Ø	7	8	10
cutting insert	1	2	2

Calibration pin



Use: Calibration of the powder level for tamping without a strand (e.g. cut off device or cross tamping)

Calibrating diameter: 2,1 - 3,1mm
 Calibration surface: PKD tipped (diamond)

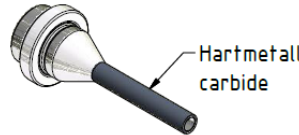

calibration Ø	for drill Ø	shaft Ø	length	Article No.
2,1	2,0	4	50	9003121
2,2	2,1	4	50	9003122
2,3	2,2	4	50	9003123
2,4	2,3	4	50	9003124
2,5	2,4	4	50	9003125
2,6	2,5	4	50	9003126
2,8	2,7	4	50	9003128
3,0	2,9	4	50	9003130
3,1	3,0	4	50	9003131

tubular ram

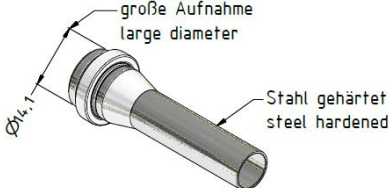
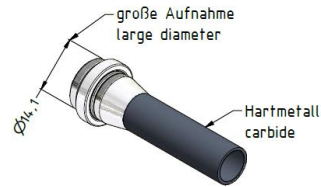
style:		usage:
00	 <p>Stahl gehärtet steel hardened</p>	<ul style="list-style-type: none"> - standard - best availability
11	 <p>Hartmetall carbide</p>	<ul style="list-style-type: none"> - for large numbers - least wear - high stability - for iron powder
01	 <p>verstärkter Schaft reinforced shaft</p>	<ul style="list-style-type: none"> - higher stability at smaller measurements (ID 0,5 – 1 mm) - due to the reinforced shaft the maximum tamping-depth is reduced
02	 <p>verstärkter Schaft reinforced shaft Hartmetall carbide</p>	<ul style="list-style-type: none"> - higher stability at smaller measurements (ID 0,5 – 1 mm) - least wear - due to the reinforced shaft the maximum tamping-depth is reduced
12	 <p>große Aufnahme large diameter $\phi_{\text{max}} 1$ Stahl gehärtet steel hardened</p>	<ul style="list-style-type: none"> - for heavy tamping head only - standard
13	 <p>große Aufnahme large diameter $\phi_{\text{max}} 1$ Hartmetall carbide</p>	<ul style="list-style-type: none"> - for heavy tamping head only - for large numbers - least wear - high stability - for iron powder

wall thickness:

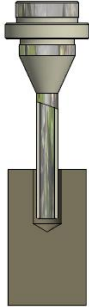
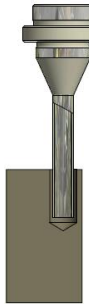
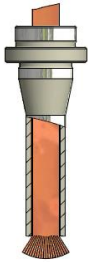
	standard: " "	thin walled "S"	thick walled "U"
usage:	Stable circumstances best durability	Fragile material close to edge	For splitting up, fine cables, for bigger drills / tamping on cut-off devices
			

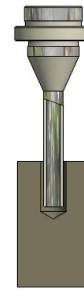
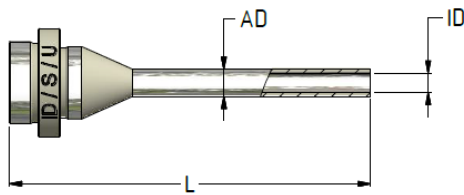

wall thickness = standard

Cable Ø LD	Inner Ø ID	Outer Ø AD	Length L	Drill hole Ø	Drill depth max.	Style	Tubular ram hardened steel	Style	Tubular ram carbide
							Article No.		Article No.
0,3	0,5	1,1	40	1,3	10	00	051104000		
0,4	0,6	1,2	40	1,4	10	00	061204000		
0,5	0,7	1,3	40	1,5	10	00	071304000		
0,6	0,8	1,4	40	1,6	10	00	081404000		
0,7	0,9	1,5	40	1,7	10	00	091504000	11	091504011
0,8	1,0	1,6	40	1,8	10	00	101604000		
0,9	1,1	1,7	40	1,9	10	00	111704000		
1,0	1,2	1,8	40	2,0	10	00	121804000	11	121804011
1,1	1,3	1,9	40	2,1	10	00	131904000		
1,2	1,4	2,0	40	2,2	10	00	142004000		
1,3	1,5	2,1	40	2,4	10	00	152104000	11	152104011
1,4	1,6	2,2	40	2,5	10	00	162204000		
1,5	1,7	2,3	40	2,6	10	00	172304000	11	172304011
1,6	1,8	2,4	40	2,7	10	00	182404000		
1,7	1,9	2,5	40	2,8	10	00	192504000		
1,8	2,0	2,8	40	3,1	10	00	202804000		
1,9	2,1	2,9	50	3,2	20	00	212905000		
2,0	2,2	3,0	50	3,3	20	00	223005000		
2,1	2,3	3,1	50	3,4	20	00	233105000		
2,2	2,4	3,2	50	3,5	20	00	243205000		
2,4	2,6	3,4	50	3,7	20	00	263405000	11	263405011
2,5	2,7	3,5	50	3,8	20	00	273505000		
2,6	2,8	3,6	50	3,9	20	00	283605000		
2,7	2,9	3,7	50	4,0	20	00	293705000		
2,8	3,0	3,8	50	4,1	20	00	303805000		
2,9	3,1	3,9	50	4,2	20	00	313905000		
3,0	3,2	4,0	50	4,3	20	00	324005000		
3,1	3,3	3,4	50	3,7	20	00	334105000	11	334105011
3,2	3,4	4,2	50	4,5	20	00	344205000		
3,3	3,5	4,3	50	4,6	20	00	354305000		
3,4	3,6	4,4	50	4,7	20	00	364405000		
3,5	3,7	4,5	50	4,8	20	00	374505000		
3,6	3,8	4,6	50	4,9	20	00	384605000		
3,7	3,9	4,7	50	5,0	20	00	394705000	11	394605011
3,8	4,0	4,8	50	5,1	20	00	404805000		
3,9	4,1	4,9	50	5,2	20	00	414905000	11	414905011
4,0	4,2	5,2	50	5,5	20	00	425205000		
4,1	4,3	5,3	50	5,6	20	00	435305000		
4,2	4,4	5,4	50	5,7	20	00	445405000		
4,3	4,5	5,5	50	5,8	20	00	455505000	11	455505011
4,4	4,6	5,6	50	5,9	20	00	465605000		
4,5	4,7	5,7	50	6,0	20	00	475705000		
4,6	4,8	5,8	50	6,1	20	00	485805000	11	485805011

Cable Ø LD	Inner Ø ID	Outer Ø AD	Length L	Drill hole Ø	Drill depth max.	Style	Tubular ram hardened steel	Style	Tubular ram carbide
							Article No.		Article No.
4,8	5,0	6,0	50	6,3	20	00	506005000		
4,8	5,0	6,1	50	6,4	20	00	516105000		
5,0	5,2	6,2	50	6,5	20	00	526205000	11	526205011
5,2	5,4	6,4	50	6,7	20	00	546405000		
5,3	5,5	6,5	50	6,8	20	00	556505000		
5,5	5,7	6,7	50	7,0	20	00	576705000		
5,6	5,8	6,8	50	7,1	20	00	586805000		
5,6	5,8	6,8	55	7,1	25	00	586805500		
5,8	6,0	7,0	50	7,3	20	00	607005000		
5,9	6,1	7,1	50	7,4	20	00	617105000		
6,0	6,2	7,2	50	7,5	20	00	627205000	11	627205011
6,1	6,3	7,3	50	7,6	20	00	637305000	11	637305011
6,2	6,4	7,4	50	7,7	20	00	647405000		
6,3	6,5	7,5	50	7,8	20	00	657505000		
6,5	6,7	7,7	50	8,0	20	00	677705000	11	677705011

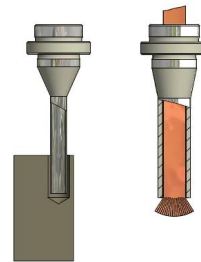
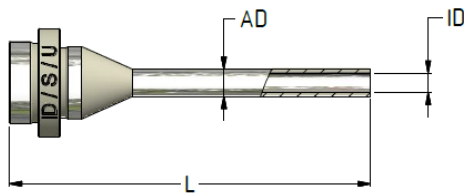

wall thickness = thin walled / thickwalled

Cable Ø LD	Inner Ø ID	Outer Ø AD	Length L	Drill hole Ø	Drill depth max.	Style	wall thickness	Tubular ram hardened steel	Style	wall thickness	Tubular ram carbide
								Article No.			Article No.
0,3	0,5	0,9	40	1,1	10	00	S	050904000			
0,4	0,6	1,0	40	1,2	10	00	S	061004000			
0,5	0,6	1,0	40	1,2	10	00	S	071004000			
0,6	0,8	1,2	40	1,4	10	00	S	081204000			
0,6	0,8	1,2	40	1,4	10	01	S	081204001	01	S	081204001
0,7	0,9	1,3	40	1,5	10	00	S	091304000	11	S	091304011
0,8	1,0	1,5	40	1,7	10	00	S	101504000			
0,8	1,0	1,4	40	1,6	10	00	S	101404000			
0,9	1,1	1,4	40	1,6	10	00	S	111404000			
0,9	1,1	1,5	40	1,7	10	00	S	111504000			
1,0	1,2	1,6	40	1,8	10	00	S	121604000			
1,1	1,3	1,8	40	2,0	10	00	S	131804000			
1,1	1,3	1,7	40	1,9	10	00	S	131704000			
1,2	1,4	1,8	40	2,0	10	00	S	141804000	11	S	141804011
1,2	1,4	2,3	40	2,5	10	00	U	142304000			
1,3	1,5	1,9	40	2,2	10	00	S	151904000			
1,4	1,6	1,9	40	2,2	10	00	S	161904000			
1,4	1,6	2,0	40	2,3	10	00	S	162004000			
1,4	1,6	2,1	40	2,4	10	00	S	162104000			
1,5	1,7	2,1	40	2,4	10	00	S	172104000			
1,6	1,8	2,3	40	2,6	10	00	S	182304000			

Cable Ø LD	Inner Ø ID	Outer Ø AD	Length L	Drill hole Ø	Drill depth max.	Tubular ram hardened steel		Tubular ram carbide			
						Style	wall thickness	Style	wall thickness		
						Article No.		Article No.			
1,8	2,0	2,4	40	2,7	10	00	S	202404000			
1,9	2,1	2,7	50	3,0	20	00	S	212705000			
1,9	2,1	2,5	50	2,8	20	00	S	212505000			
2,0	2,2	2,8	50	3,1	20	00	S	222805000			
2,0	2,2	2,6	50	2,9	20	00	S	222605000			
2,1	2,3	3,0	50	3,3	20	00	S	233005000			
2,1	2,3	2,8	50	3,1	20	00	S	232805000			
2,1	2,3	2,7	50	3,0	20	00	S	232705000			
2,2	2,4	3,1	50	3,4	20	00	S	243105000			
2,2	2,4	3,0	50	3,3	20	00	S	243005000			
2,2	2,4	2,8	50	3,1	20	00	S	242805000			
2,4	2,6	3,0	50	3,3	20	00	S	263005000			
2,5	2,7	3,4	50	3,7	20	00	S	273405000			
2,6	2,8	3,4	50	3,7	20	00	S	283405000			
2,7	2,9	3,3	50	3,6	20	00	S	293305000			
2,8	3,0	3,6	50	3,9	20	00	S	303605000			
2,9	3,1	3,5	50	3,8	20	00	S	313505000			
3,0	3,2	3,8	50	4,1	20	00	S	323805000			
3,0	3,2	3,6	50	3,9	20	00	S	323605000			
3,1	3,3	3,7	50	4,0	20	00	S	333705000			
3,4	3,6	4,0	50	4,3	20	00	S	354005000			
3,4	3,6	4,0	50	4,3	20	00	S	364005000			
3,5	3,7	4,3	50	4,6	20	00	S	374305000			
3,6	3,8	4,5	50	4,8	20	00	S	384505000			
3,6	3,8	4,2	50	4,5	20	00	S	384205000			
3,7	3,9	4,6	50	4,9	20	00	S	394605000			
3,8	4,0	5,0	50	5,3	20	00	U	405005000			
3,9	4,1	4,8	50	5,1	20	00	S	414805000	11	S	414805011
3,9	4,1	4,5	50	4,8	20	00	S	414505000			
3,9	4,1	4,6	50	4,9	20				11	S	414605011
4,0	4,2	5,1	50	5,4	20	00	S	425105000			
4,0	4,2	5,0	50	5,3	20	00	S	425005000			
4,0	4,2	4,6	50	4,9	20	00	S	424605000			
4,2	4,4	5,2	50	5,5	20	00	S	445205000			
4,3	4,5	5,2	50	5,5	20	00	S	455205000			
4,4	4,6	5,3	50	5,6	20	00	S	465305000			
4,5	4,7	5,4	50	5,7	20	00	S	475405000			
4,6	4,8	5,2	50	5,5	20	00	S	485205000			
4,8	5,0	5,8	50	6,1	20	00	S	505805000			
4,9	5,1	5,9	50	6,2	20	00	S	515905000			
5,0	5,2	5,6	50	5,9	20	00	S	525605000			
5,3	5,5	5,9	50	6,2	20	00	S	555905000			
5,5	5,7	6,1	50	6,4	20	00	S	576105000			
6,0	6,2	7,3	50	7,6	20				11	U	627305011
6,3	6,5	7,6	55	7,9	25	00	U	657605500			
6,5	6,7	7,1	50	7,4	20	00	S	677105000			

different sizes on demand

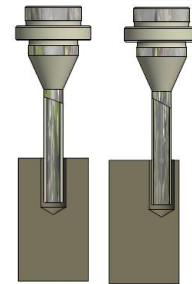
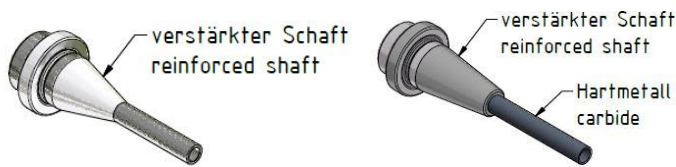

Tubular ram with reinforced shaft

Cable Ø LD	Inner Ø ID	Outer Ø AD	Length L	Drill hole Ø	Drill depth max.	Style	wall thickness	Tubular ram with reinforced shaft hardened steel	Style	wall thickness	Tubular ram with reinforced shaft carbide
								Article No.			Article No.
0,3	0,5	1,1	40	1,3	6	01		051104001	02		051104002
0,3	0,5	0,9	40	1,1	6	01	S	050904001	02	S	050904002
0,4	0,6	1,2	40	1,4	6	01		061204001	02		061204002
0,4	0,6	1,0	40	1,2	6	01	S	061004001	02	S	061004002
0,5	0,7	1,3	40	1,5	6	01		071304001	02		071304002
0,5	0,7	1,0	40	1,2	6	01	S	071004001	02	S	071004002
0,6	0,8	1,4	40	1,6	6	01		081404001	02		081404002
0,6	0,8	1,2	40	1,4	6	01	S	081204001	02	S	081204002
0,7	0,9	1,5	40	1,7	6	00		091504001	02		091504002
0,7	0,9	1,3	40	1,5	6	01	S	091304001	02	S	091304002
0,8	1,0	1,6	40	1,8	6	00		101604001	02		101604002
0,8	1,0	1,5	40	1,7	6	00	S	101504001	02	S	101504002
0,8	1,0	1,4	40	1,6	6	00	S	101404001	02	S	101404002

different sizes on demand

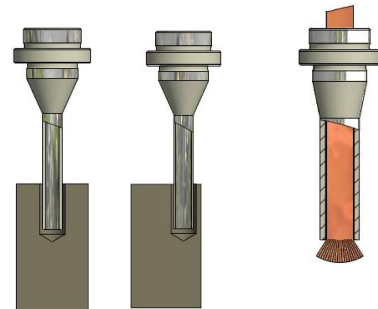
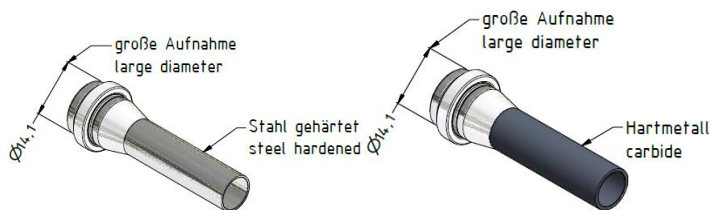

Tubular ram for heavy tamping head

Cable Ø LD	Inner Ø ID	Outer Ø AD	Length L	Drill hole Ø	Drill depth max.	Style	wall thickness	Tubular ram for heavy tamping head hardened steel	Style	wall thickness	Tubular ram for heavy tamping head carbide
								Article No.			Article No.
6,7	6,9	7,7	50	8,0	20	12	S	697705012	13	S	697705013
6,8	7,0	8,0	50	8,3	20	12		708005012			
7,5	7,7	8,7	50	9,0	20	12		778705012			
7,7	7,9	8,9	50	9,0	20	12		798905012			
8,3	8,5	10,2	50	10,8	20	12	U	851025012	13	U	851025013
8,4	8,6	9,6	50	10,2	20	12		869605012			

different sizes on demand

tamping punch

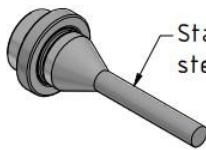

Stahl gehärtet
steel hardened

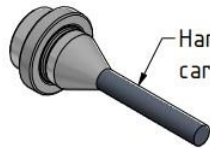

Hartmetall
carbide

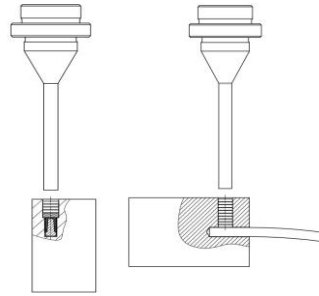

use: for tamping on cut off devices, or cross tamping

punch Ø	Inner Ø ID	Outer Ø AD	Length L	Drill hole Ø	Drill depth max.	Tamping punch hardened steel	Tamping punch carbide
						Article No.	Article No.
1,1	0	1,1	40	1,3	10	001104000	001104001
1,2	0	1,2	40	1,5	10	001204000	001204001
1,5	0	1,5	40	1,7	10	001504000	001504001
1,7	0	1,7	40	1,9	10	001704000	001704001
2,1	0	2,1	40	2,3	10	002104000	002104001
2,4	0	2,4	40	2,6	10	002404000	002404001
2,5	0	2,5	40	2,7	10	002504000	002504001
2,9	0	2,9	40	3,1	10	002904000	002904001

different sizes on demand

blanking punch / blanking plate / impress punch / holding disc

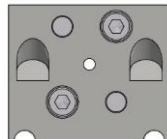
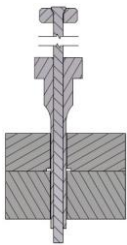

punch Ø AD	Inner Ø ID	blanking punch Type 100E2275	blanking plate Type 100 92300	Outer Ø AD	impress punch Type AV2 2031	Inner Ø ID	holding disc Type AV2 20018
		Article No.	Article No.		Article No.		Article No.
2,25	1,8	1822504100	BSL100 92300_250	1,7	AV2 20031_17	1,7	AV2 20018_17
2,30	1,8	1823004100	BSL100 92300_230				
2,35	1,8	1823504100	BSL100 92300_235				
2,515	1,9	1925154100	BSL100 92300_2515	1,8	AV2 20031_18	1,8	AV2 20018_18
2,55	1,9	1925504100	BSL100 92300_255				
2,615	1,9	1926154100	BSL100 92300_2615				
2,78	1,9	1927804100	BSL100 92300_278				
2,80	2,0	2028004100	BSL100 92300_280	1,9	AV2 20031_19	1,90	AV2 20018_19
3,10	2,0	2031004100	BSL100 92300_310				
3,15	2,2	2231504100	BSL100 92300_315	2,1	AV2 20031_21	2,1	AV2 20018_21
3,185	2,2	2231854100	BSL100 92300_3185				
3,20	2,5	2532004100	BSL100 92300_320	2,4	AV2 20031_24	2,4	AV2 20018_24
3,25	2,3	2332504100	BSL100 92300_325	2,2	AV2 20031_22	2,2	AV2 20018_22

different sizes on demand

collet for standard tamping head

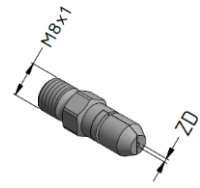
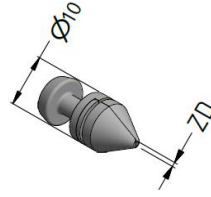
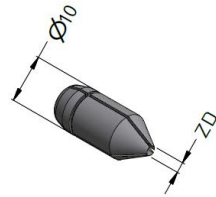

Cable \varnothing	Inner \varnothing ZD	collet without thread three parts For standard tamping head	collet without thread two parts For standard tamping head	collet with thread two parts For standard tamping head
		Article No.	Article No.	Article No.
0	-	-	-	Z12960300 (without drillhole)
0,3	0,5	-	Z12960205	Z12960305
0,4	0,6	-	Z12960206	Z12960306
0,5	0,7	-	Z12960207	Z12960307
0,6	0,8	-	Z12960208	Z12960308
0,7	0,9	-	Z12960209	Z12960309
0,8	1,0	-	Z12960210	Z12960310
0,9	1,1	-	Z12960211	Z12960311
1,0	1,2	-	Z12960212	Z12960312
1,1	1,3	-	Z12960213	Z12960313
1,2	1,4	-	Z12960214	Z12960314
1,3	1,5	Z12960115	-	Z12960315
1,4	1,6	Z12960116	-	Z12960316
1,5	1,7	Z12960117	-	Z12960317
1,6	1,8	Z12960118	-	Z12960318
1,7	1,9	Z12960119	-	Z12960319
1,8	2,0	Z12960120	-	Z12960320
1,9	2,1	Z12960121	-	Z12960321
2,0	2,2	Z12960122	-	Z12960322
2,1	2,3	Z12960123	-	Z12960323
2,2	2,4	Z12960124	-	Z12960324
2,3	2,5	Z12960125	-	-
2,4	2,6	Z12960126	-	-
2,5	2,7	Z12960127	-	-
2,6	2,8	Z12960128	-	-
2,7	2,9	Z12960129	-	-
2,8	3,0	Z12960130	-	-
2,9	3,1	Z12960131	-	-
3,0	3,2	Z12960132	-	-
3,1	3,3	Z12960133	-	Z12960333
3,2	3,4	Z12960134	-	-
3,3	3,5	Z12960135	-	-
3,4	3,6	Z12960136	-	-
3,5	3,7	Z12960137	-	-
3,6	3,8	Z12960138	-	-
3,7	3,9	Z12960139	-	-
3,8	4,0	Z12960140	-	-
3,9	4,1	Z12960141	-	-
4,0	4,2	Z12960142	-	-
4,1	4,3	Z12960143	-	-
4,2	4,4	Z12960144	-	-
4,3	4,5	Z12960145	-	-

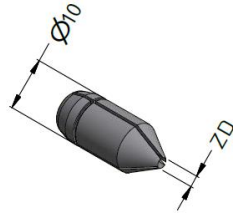

Cable \varnothing	Inner \varnothing ZD	collet without thread three parts For standard tamping head	
		Article No.	remark
4,4	4,6	Z12960146	
4,5	4,7	Z12960147	
4,6	4,8	Z12960148	
4,7	4,9	Z12960149	
4,8	5,0	Z12960150	
4,9	5,1	Z12960151	
5,0	5,2	Z12960152	
5,1	5,3	Z12960153	
5,2	5,4	Z12960154	
5,3	5,5	Z12960155	
5,4	5,6	Z12960156	
5,5	5,7	Z12960157	
5,6	5,8	Z12960158	
5,7	5,9	Z12960159	
5,8	6,0	Z12960160	
5,9	6,1	Z12960161	
6,0	6,2	Z12960162	
6,1	6,3	Z12960163	
6,2	6,4	Z12960164	
6,3	6,5	Z12960165	
6,4	6,6	Z12960166	
6,5	6,7	Z12960167	
6,7	6,9	Z12960169	Only with special clamping tube
6,8	7,0	Z12960170	Only with special clamping tube
7,5	7,7	Z12960177	Only with special clamping tube
7,7	7,9	Z12960179	Only with special clamping tube
7,8	8,0	Z12960180	Only with special clamping tube
8,4	8,6	Z12960186	Only with special clamping tube

different sizes on demand

collet for small tamping head

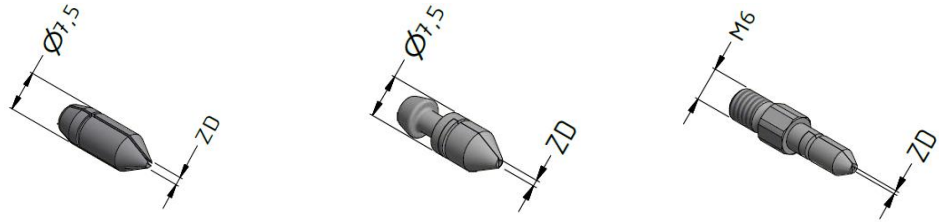

Cable Ø	Inner Ø ZD	collet without thread three parts For small tamping head	collet without thread two parts For small tamping head	collet with thread two parts For small tamping head
		Article No.	Article No.	Article No.
0	-	-	-	Z12960400 (without drill hole)
0,1	0,3	-	-	Z12960403
0,2	0,4	-	-	Z12960404
0,3	0,5	-	Z12960605	Z12960405
0,4	0,6	-	Z12960606	Z12960406
0,5	0,7	-	Z12960607	Z12960407
0,6	0,8	-	Z12960608	Z12960408
0,7	0,9	-	Z12960609	Z12960409
0,8	1,0	-	Z12960610	Z12960410
0,9	1,1	-	Z12960611	Z12960411
1,0	1,2	-	Z12960612	Z12960412
1,1	1,3	-	Z12960613	Z12960413
1,2	1,4	-	Z12960614	Z12960414
1,3	1,5	Z12960515	-	Z12960415
1,4	1,6	Z12960516	-	Z12960416
1,5	1,7	Z12960517	-	Z12960417
1,6	1,8	Z12960518	-	Z12960418
1,7	1,9	Z12960519	-	Z12960419
1,8	2,0	Z12960520	-	Z12960420
1,9	2,1	Z12960521	-	Z12960421
2,0	2,2	Z12960522	-	Z12960422
2,1	2,3	Z12960523	-	-
2,2	2,4	Z12960524	-	Z12960424
2,3	2,5	Z12960525	-	-
2,4	2,6	Z12960526	-	-
2,5	2,7	Z12960527	-	-
2,6	2,8	Z12960528	-	-
2,7	2,9	Z12960529	-	-
2,8	3,0	Z12960530	-	-
2,9	3,1	Z12960531	-	Z12960431
3,0	3,2	Z12960532	-	-
3,1	3,3	Z12960533	-	-
3,2	3,4	Z12960534	-	-
3,3	3,5	Z12960535	-	-
3,4	3,6	Z12960536	-	-

collet for super light tamping head

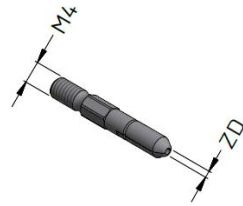

Cable Ø	Inner Ø ZD	collet with thread two parts For super light tamping head	Article No.	Cable Ø	Inner Ø ZD	collet with thread two parts For super light tamping head	Article No.
0	-		Z12960900 (without drill hole)	1,3	1,5		Z12960915
0,1	0,3		Z12960903	1,4	1,6		Z12960916
0,2	0,4		Z12960904	1,5	1,7		Z12960917
0,3	0,5		Z12960905	1,6	1,8		Z12960918
0,4	0,6		Z12960906	1,7	1,9		Z12960919
0,5	0,7		Z12960907	1,8	2,0		Z12960920
0,6	0,8		Z12960908	1,9	2,1		Z12960921
0,7	0,9		Z12960909	2,0	2,2		Z12960922
0,8	1,0		Z12960910	2,1	2,3		Z12960923
0,9	1,1		Z12960911	2,2	2,4		Z12960924
1,0	1,2		Z12960912				
1,1	1,3		Z12960913				
1,2	1,4		Z12960914				

collet for heavy tamping head

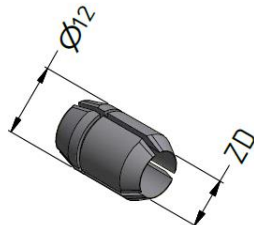

Cable Ø	Inner Ø ZD	collet without thread three parts For heavy tamping head	Article No.	Cable Ø	Inner Ø ZD	collet without thread three parts For heavy tamping head	Article No.
0	0		Z12961300 (without drill hole)	4,6-4,8	5,0		Z12961350
2,2-2,4	2,6		Z12961326	4,9-5,2	5,4		Z12961354
2,5-2,6	2,8		Z12961328	5,3-5,6	5,8		Z12961358
2,7-2,8	3,0		Z12961330	5,7-6,0	6,2		Z12961362
2,9-3,0	3,2		Z12961332	6,1-6,4	6,6		Z12961366
3,1-3,3	3,5		Z12961335	6,5-6,8	7,0		Z12961370
3,4-3,6	3,8		Z12961338	6,9-7,2	7,4		Z12961374
3,7-3,9	4,1		Z12961341	7,3-7,6	7,8		Z12961378
4,0-4,2	4,4		Z12961344	7,7-8,0	8,2		Z12961382
4,3-4,5	4,7		Z12961347	8,1-8,4	8,6		Z12961386

bottom plate

UID: drill hole of bottom plate
 AD: outer Ø tubular ram
 ID: inner Ø tubular ram (marked for easy storage in set with tubular ram)

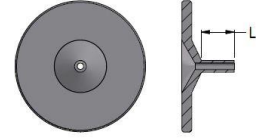
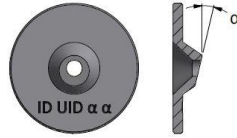
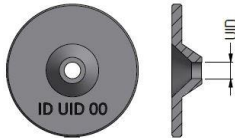
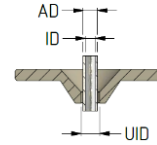

UID Ø	Bottom plate straight	α	Bottom plate oblique	L	Bottom plate with extension
	Article No.		Article No.		Article No.
1,0	ID1000	10-45	ID10αα		-
1,1	ID1100	10-45	ID11αα		-
1,2	ID1200	10-45	ID12αα		-
1,3	ID1300	10-45	ID13αα		-
1,4	ID1400	10-45	ID14αα	10(5)	-
1,5	ID1500	10-45	ID15αα	10(5)	ID1500LC1
1,6	ID1600	10-45	ID16αα	10(5)	ID1600LC1
1,7	ID1700	10-45	ID17αα	10(5)	ID1700LC1
1,8	ID1800	10-45	ID18αα	10(5)	ID1800LC1
1,9	ID1900	10-45	ID19αα	10(5)	ID1900LC1
2,0	ID2000	10-45	ID20αα	10(5)	ID2000LC1
2,1	ID2100	10-45	ID21αα	10(5)	ID2100LC1
2,2	ID2200	10-45	ID22αα		-
2,3	ID2300	10-45	ID23αα	10(5)	ID2300LC1
2,4	ID2400	10-45	ID24αα	10(5)	ID2400LC1
2,5	ID2500	10-45	ID25αα	10(5)	ID2500LC1
2,6	ID2600	10-45	ID26αα	10(5)	ID2600LC1
2,7	ID2700	10-45	ID27αα	10(5)	ID2700LC1
2,8	ID2800	10-45	ID28αα	10(5)	ID2800LC1
2,9	ID2900	10-45	ID29αα	10(5)	ID2900LC1
3,0	ID3000	10-45	ID30αα	10(5)	ID3000LC1
3,1	ID3100	10-45	ID31αα	10(5)	ID3100LC1
3,2	ID3200	10-45	ID32αα	10(5)	ID3200LC1
3,3	ID3300	10-45	ID33αα		-
3,4	ID3400	10-45	ID34αα		-
3,5	ID3500	10-45	ID35αα	10(5)	ID3500LC1
3,6	ID3600	10-45	ID36αα	10(5)	ID3600LC1
3,7	ID3700	10-45	ID37αα		-
3,8	ID3800	10-45	ID38αα	10(5)	ID3800LC1
3,9	ID3900	10-45	ID39αα	10(5)	ID3900LC1
4,0	ID4000	10-45	ID40αα		-
4,1	ID4100	10-45	ID41αα	10(5)	ID4100LC1
4,2	ID4200	10-45	ID42αα	10(5)	ID4200LC1
4,3	ID4300	10-45	ID43αα	10(5)	ID4300LC1
4,4	ID4400	10-45	ID44αα	10(5)	ID4400LC1
4,5	ID4500	10-45	ID45αα	10(5)	ID4500LC1
4,6	ID4600	10-45	ID46αα	10(5)	ID4600LC1
4,7	ID4700	10-45	ID47αα	10(5)	ID4700LC1
4,8	ID4800	10-45	ID48αα		-
4,9	ID4900	10-45	ID49αα	10(5)	ID4900LC1
5,0	ID5000	10-45	ID50αα	10(5)	ID5000LC1
5,1	ID5100	10-45	ID51αα		-
5,2	ID5200	10-45	ID52αα	10(5)	ID5200LC1
5,3	ID5300	10-45	ID53αα		-
5,4	ID5400	10-45	ID54αα		-

UID Ø	Bottom plate straight	α	Bottom plate oblique	L	Bottom plate with extension
	Article No.		Article No.		Article No.
5,5	ID5500	10-45	ID55αα		-
5,6	ID5600	10-45	ID56αα		-
5,7	ID5700	10-45	ID57αα		-
5,8	ID5800	10-45	ID58αα	10(5)	ID5800LC1
5,9	ID5900	10-45	ID59αα		-
6,0	ID6000	10-45	ID60αα		-
6,1	ID6100	10-45	ID61αα		-
6,2	ID6200	10-45	ID62αα	10(5)	ID6200LC1
6,3	ID6300	10-45	ID63αα	10(5)	ID6300LC1
6,4	ID6400	10-45	ID64αα	10(5)	ID6400LC1
6,7	ID6700	10-45	ID67αα		-
6,8	ID6800	10-45	ID68αα	10(5)	ID6800LC1
6,9	ID6900	10-45	ID69αα	10(5)	ID6900LC1
7,0	ID7000	10-45	ID70αα		-
7,2	ID7200	10-45	ID72αα		-
7,3	ID7300	10-45	ID73αα		-
7,4	ID7400	10-45	ID74αα		-
7,5	ID7500	10-45	ID75αα	10(5)	ID7500LC1
7,6	ID7600	10-45	ID76αα		-
7,7	ID7700	10-45	ID77αα	10(5)	ID7700LC1
7,8	ID7800	10-45	ID78αα		-
7,9	ID7900	10-45	ID79αα		-
8,2	ID8200	10-45	ID82αα		-
8,9	ID8900	10-45	ID89αα		-
9,7	ID9700	10-45	ID87αα		-
9,8	ID9800	10-45	ID98αα		-
10,4	ID10400	10-45	ID104αα		-

scissor blades

Use: for cutting cables in tamping machines

standard: hardened steel

carbide tipped: high performance, least wear

style angle: 45 degree cutting angle for splitting up prevention, max cable Ø 4

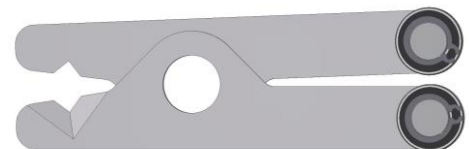
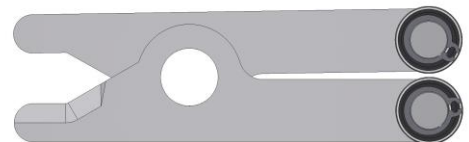

	Scissor blades article no:	Scissor blades - angle article no:
hardened steel	005E01080a	005E01080_2
carbide tipped	005E01080_1	005E01080_3

hand tamping piece

Use: for manual tamping with hammer (tests, prototyping)
for every tamping cable Ø is a tubular ram and a collet for heavy tamping head necessary.



	Hand tamper
article no:	ZUB 10010